



## 142 Curlewis Street Bondi Beach NSW

### PRIME BONDI BEACH RETAIL

Located in a prime location, approx 100 meters away from Iconic Bondi Beach & in the heart of Bondi Beach in renowned Curlewis St with adjoining tenants such as Milky Lane & F45 and around the corner from trendy Gould St, lies this exceptional retail shop of approximately 180 sqm (approx) with high visibility and strong pedestrian traffic, this property would be suitable for a variety of businesses, ready to move in and fit out to your needs.

This is a unique opportunity, ideal for a pop up shop.

Next available January 2023.

P.O.A

**View :** <https://www.rwbb.com.au/lease/nsw/eastern-suburbs/bondi-beach/commercial/retail/5932095>



**Ari Pappas**  
**8362 4000**

142 Curlewis Street  
BONDI BEACH

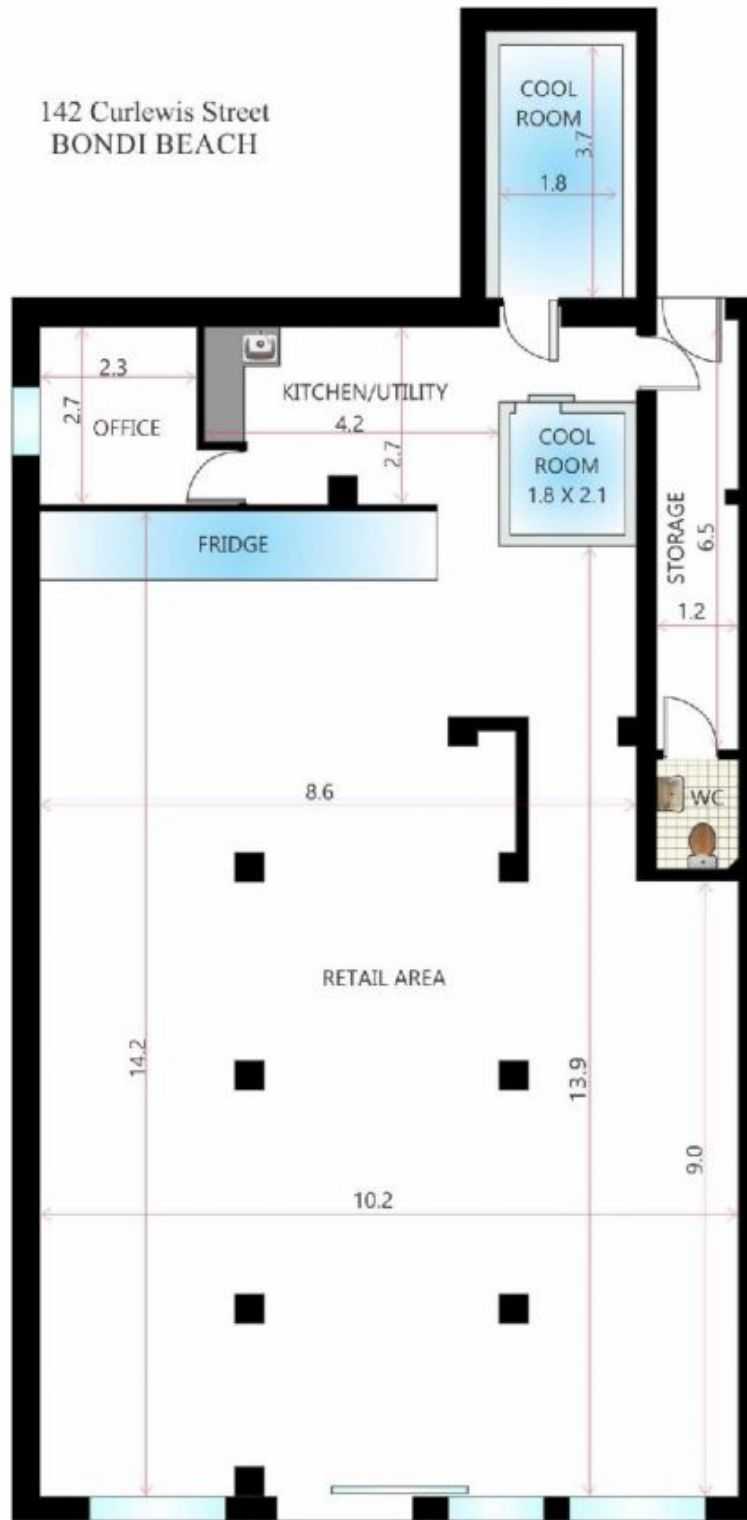

SCALE 1:100

FLOOR PLAN BY BORTEX PTY LTD PH: 0414 922 679

"The information contained herein has been provided by our Principal and third parties, which we merely pass on without any representation or warranty given, intended or implied by us as to its correctness and with no liability accepted by us in this regard. You must rely on your own inquiries as to its accuracy or otherwise."